

Handheld Scanners

Z-3051BT

Wide Angle Laser Wireless Scanner



Features

- **Wireless freedom**
 - Wireless feature with up to 100m connection range
- **Data connection flexibilities**
 - To be connected by the cradle, dongle or any frequency hopping device, such as PDA, laptop, smart phone and etc.
- **Reliable scanning accuracy**
 - Symbol scan engine equipped with up to 36 scans per second
- **Scanning signals**
 - Flashing LED indication as well as programmable beeper
- **Handy operation**
 - Light-weighted and streamlined shape for easy-to-handle experience
- **Scan operation**
 - Handheld scan or hands-free with stand

Applications

Point-of-Sale
Stock control
Logistics tracking
Document tracking
Asset management

Z-3051BT, the desirable wireless single-line laser scanner, offers the opportunity of having an efficient working environment with 100% freedom, and thus having their pleasant business and customer. Shipping industry, cargo warehouses, superstores, pharmacies, and many more open-space or large-scale manufacturing sites will be delighted to enjoy this move-around freedom.

As far as 100-meter connection range, all scanned data are instantly transferred to the connected frequency hopping device which can be the cradle, the dongle or any device with serial protocol profile connectivity. Otherwise, the embedded 32KB flash memory provides sufficient data space while the stored data will be automatically passes over to the receiver once inside the range again.

Furthermore, light-weighted, streamlined and yet equipped with Symbol scan engine, Z-3051BT delivers hazel-free operations even during the rush hours. Its scanning sensitivity and accuracy are both secured by instant hardware decode technology, decoding most of popular 1D barcodes. In words, Z-3051BT is more than a scanner but a trusted tool partner.





Specifications

OPERATIONAL	
Light Source	650 nm visible laser diode (VLD)
Depth of Field	0 - 559 mm for UPC/EAN 100%
Width of Field	0 - 508 mm
Scan Rate	36 scans per second
Number of Scan Lines	Single
Minimum Bar Width	5 mil @ PCS 90% (0.1mm actual)
Print Contrast	30% @ UPC/EAN 100%
Indicators (LED)	Three-color LED (green, red & blue)
Beeper Operation	Programmable tone and beep time
System Interfaces	Keyboard, RS-232C, USB1.1, wand
PHYSICAL	
Height	165.16 mm
Depth	175.13 mm
Width	92.0 mm
Weight	200g (stand excluded); 563g (with stand)
Cable	Standard 2m straight
ELECTRICAL	
Input Voltage	9V DC 1A
Battery	2 AA NiMH rechargeable batteries
Operating Autonomy	Over 24,000 reads at full charged by scanning once per second
Recharge Time	5 Hours (max.)
RADIO COMMUNICATION	
Protocol	Blue tooth 1.2 Serial Protocol Profile (SPP)
Radio Frequency	2.4 - 2.48 GHz
Working Range	Class 1 up to 100m/75m (depends on the operating environment)
REGULATORY	
Laser Class	CDRH class II; IEC 60825-1 class 1
EMC	CE & FCC DOC compliance
Radio	FCC TCB, EN 300 328, ARIB STD-T66
ENVIRONMENTAL	
Operating Temperature	0°C - 40°C (32°F - 104°F)
Storage Temperature	-20°C - 60°C (-4°F - 140°F)
Humidity	5% - 90% RH (non-condensing)
Ambient Light Injection	4,500 LUX (fluorescence)
Shock	Designed to withstand 1m drops

Dimensions

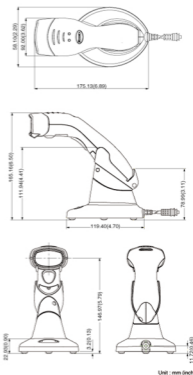

* Product availability & specifications depend on territory market strategy; all are subjects to change without prior notice.

** ZEBEX is the trademark of ZEBEX INDUSTRIES INC.; all rights reserved.